

WHEREAS it is deemed desirable to amend the "Village of Port Clements Zoning By-law No. 41, 1977" to zone this property;

NOW THEREFORE, the Council of the Village of Port Clements in open meeting assembled enacts as follows:

1. That the Village of Port Clements Zoning By-law No. 41, 1977 is hereby amended by:

(a) Schedule "A" of the Village of Port Clements Zoning By-law No. 41 1977 is hereby amended by rezoning Lots 1-4, Block 21, Plan 1079 from Industrial to Commercial Zone as shown on the attached map marked "Schedule A" to By-law No. 85, 1980 and outlined in red.

(b) Schedule "A" of the Village of Port Clements Zoning By-law No. 41, 1977 is hereby amended by rezoning Lots 1-8, Block 40, Plan 1079 from Multiple Dwelling to Residential Zone.

Lots 1-24, Block 39, Plan 1079 from Multiple Dwelling to Residential Zone.

That part of Section 28 currently zoned as Multiple Dwelling from Multiple Dwelling to Residential Zone, as shown on the attached map marked Schedule "B" to By-law No. 84, 1980 and outlined in red.

2. This By-law may be cited as the Village of Port Clements Zoning By-law No. 41, 1977 amendment By-law No. 85, 1980.

READ A FIRST TIME THIS 28th day of April , 1980.

READ A SECOND TIME THIS 28th day of April , 1980.

READ A THIRD TIME THIS 28th day of April , 1980.

A public hearing was held on the 31st day of March, 1980 pursuant to Section 703 of the Municipal Act.

RECONSIDERED AND ADOPTED THIS 12th day of May , 1980.

S. P. Palmer
MAYOR

D. O'Brien
CLERK

I hereby certify that this is a true and correct copy of the Village of Port Clements Zoning By-law No. 41, 1977 amendment By-law No. 85, 1980 as adopted by the Council of the Village of Port Clements this 12th day of May , 1980.

D. O'Brien
CLERK

A true copy of By-Law No. 85 registered in the office of the Inspector of Municipalities this 20th day of May 1980.
[Signature]
Deputy Inspector of Municipalities

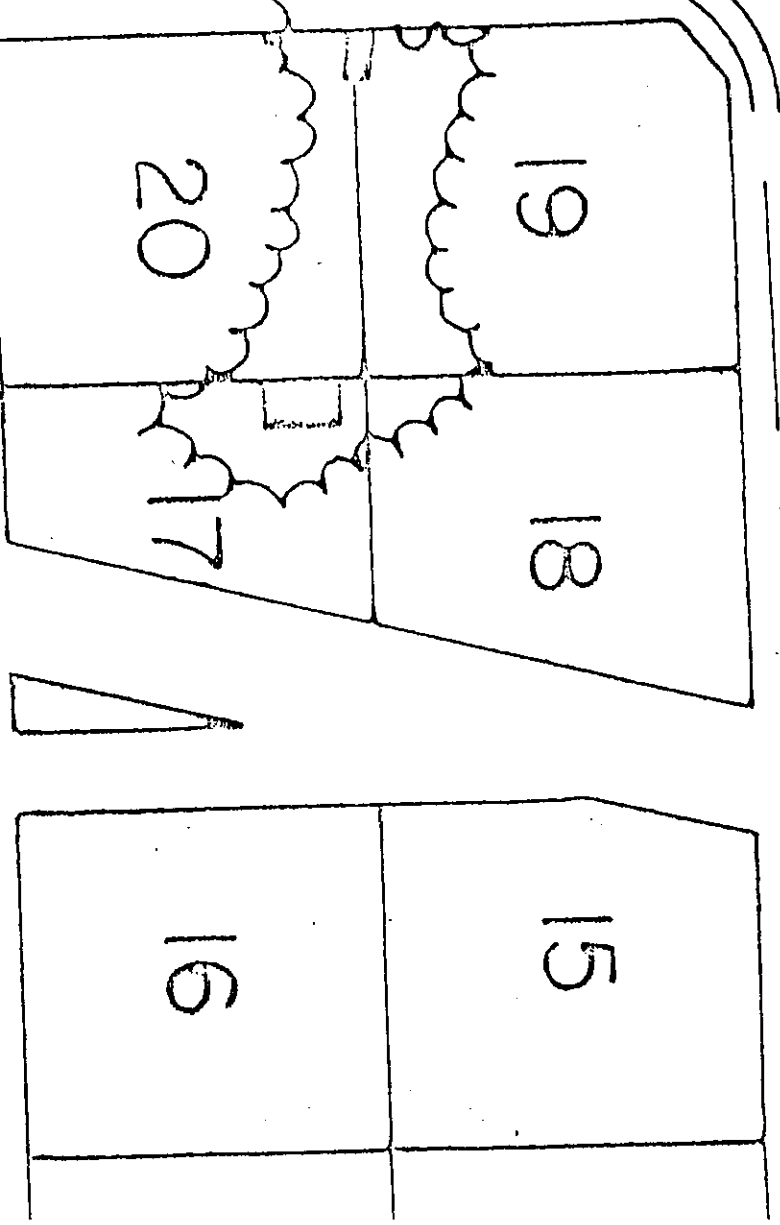
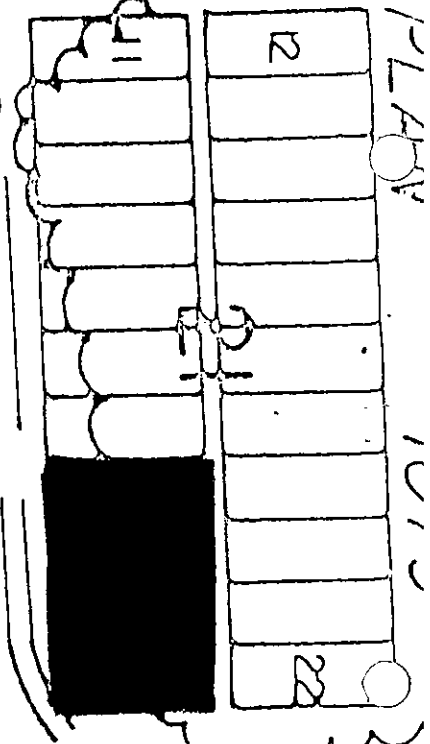

PLAN 1913
 PLAN 1974
 B

2
 PLAN
 6416

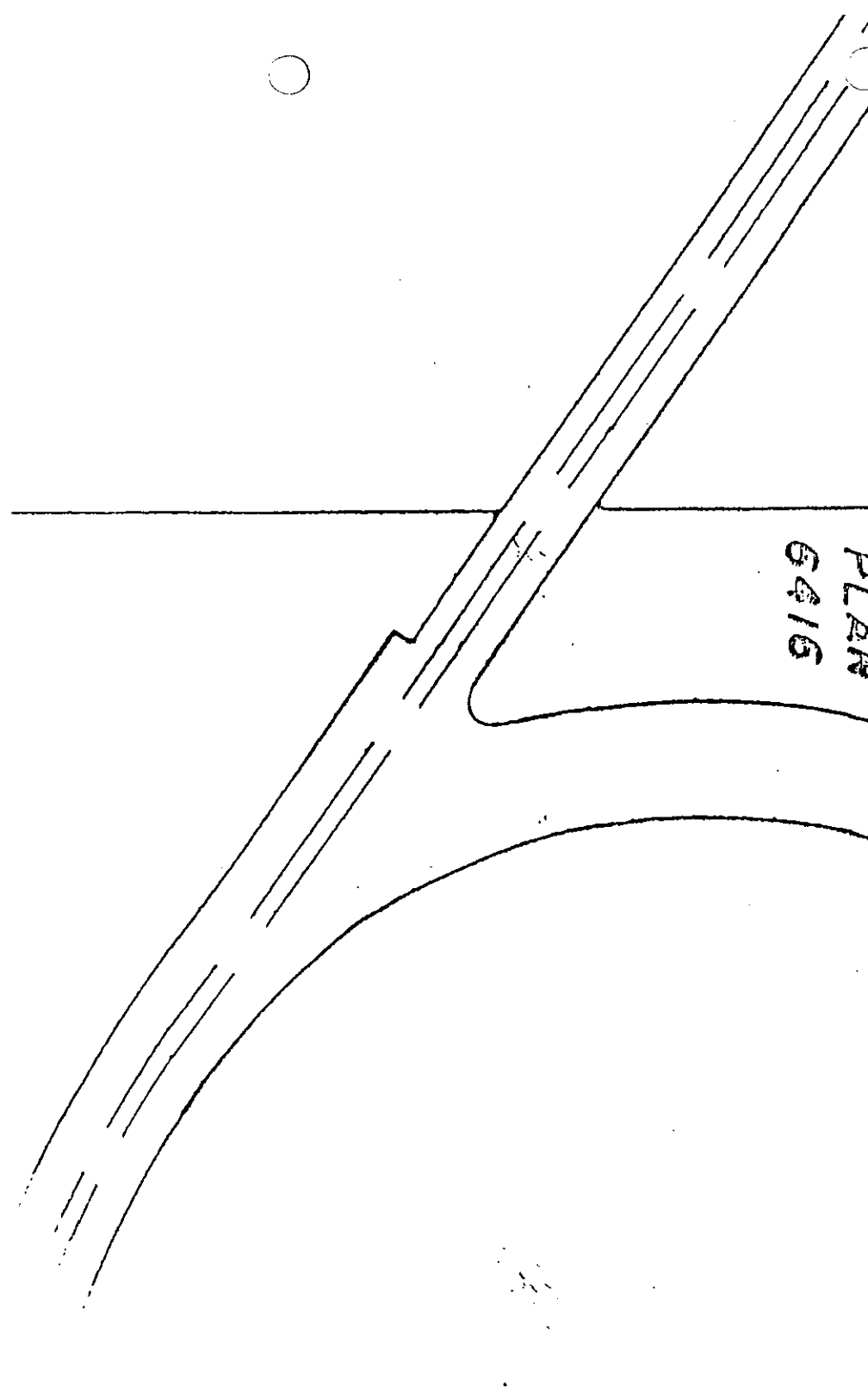

16									
----	--	--	--	--	--	--	--	--	--

--	--	--	--	--	--	--	--	--	--

--	--	--	--	--	--	--	--	--	--

16									
----	--	--	--	--	--	--	--	--	--

--	--	--	--	--	--	--	--	--	--

2									
---	--	--	--	--	--	--	--	--	--

PLAN

21079

PLAN 699

13									
----	--	--	--	--	--	--	--	--	--

--	--	--	--	--	--	--	--	--	--

13									
----	--	--	--	--	--	--	--	--	--

--	--	--	--	--	--	--	--	--	--

--	--	--	--	--	--	--	--	--	--

--	--	--	--	--	--	--	--	--	--

13									
----	--	--	--	--	--	--	--	--	--

--	--	--	--	--	--	--	--	--	--

28



3040

